

BLOME SURFACERTOPPING

REINFORCEMENT CLOTH
6" WIDE

PLASTIC TAPE
2" WIDE

EXPANSION JOINT
COMPOUND

CLOSED CELL FOAM
EXPANSION BOARD

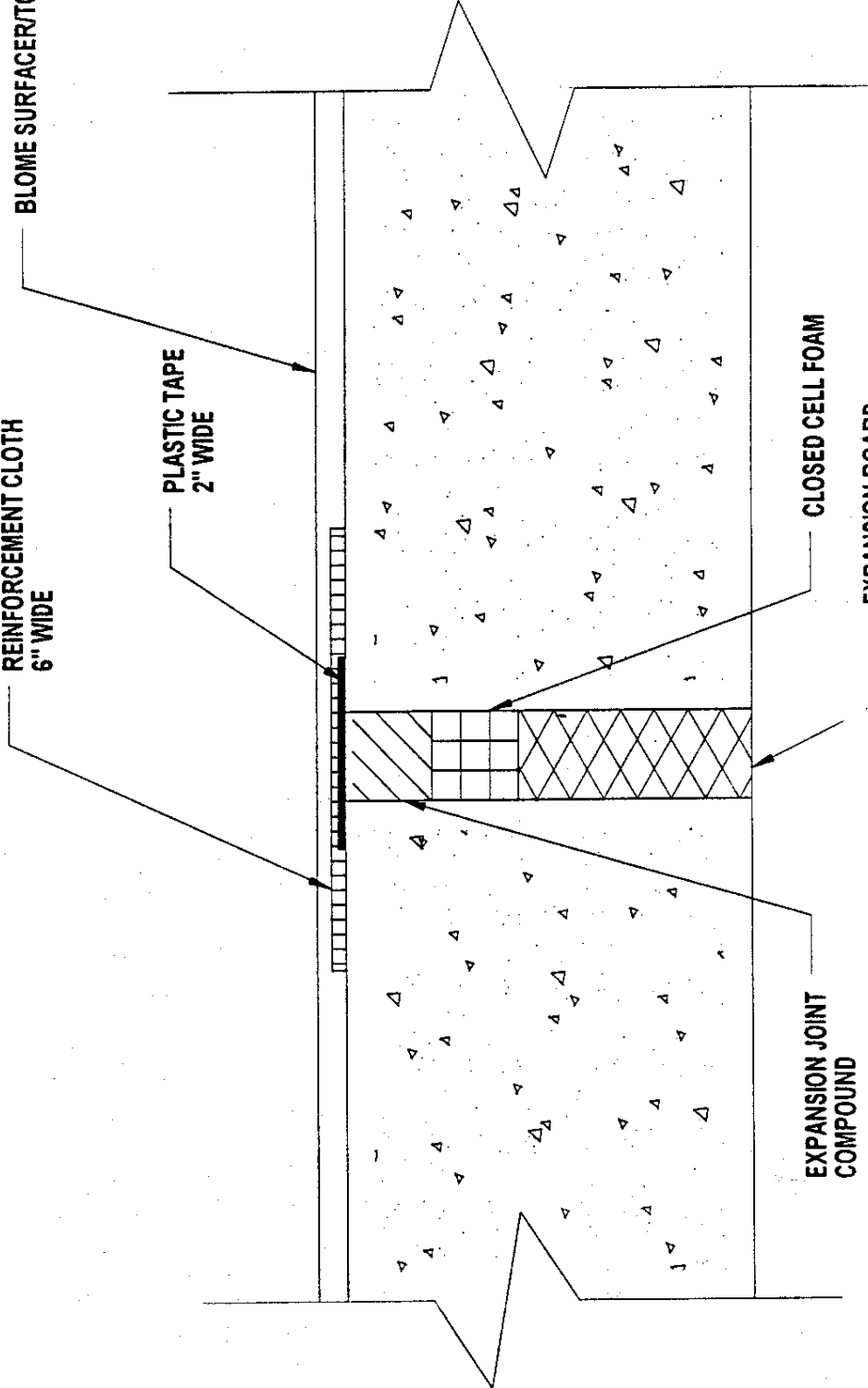

REINFORCED SURFACER OVER EXPANSION JOINTS
WITH MINIMAL MOVEMENT

ECD-1009



1450 Hoff Industrial Drive
O'Fallon, MO 63366
636-379-9119 fax 636-379-0388
www.blome.com e-mail info@blome.com